



Cincinnati Children's Hospital Translational Cores

Goal: Support Translational Research efforts of CCHMC

Pre-clinical Development

- Controlled safety studies to support regulatory approvals

Vector Core and Clinical Vector Production

- Provide high quality reagents for product development-human cells in the laboratory and animal models of human diseases
- Manufacture viral vectors for early human clinical trials

Cell Manipulations Lab

- Perform gene transfer into patient cells for re-infusion

Translational Trials Development and Support Lab

- Provide safety and efficacy testing for clinical trials.

CCHMC Translational Core Facility (Winter 2008)

Total Space: 11,000 sq ft



CCHMC Translational Core Facility (Winter 2008)

TTDSL and Pre-clinical: 3 room PCR suite, GCP lab, QC lab and preclinical lab.

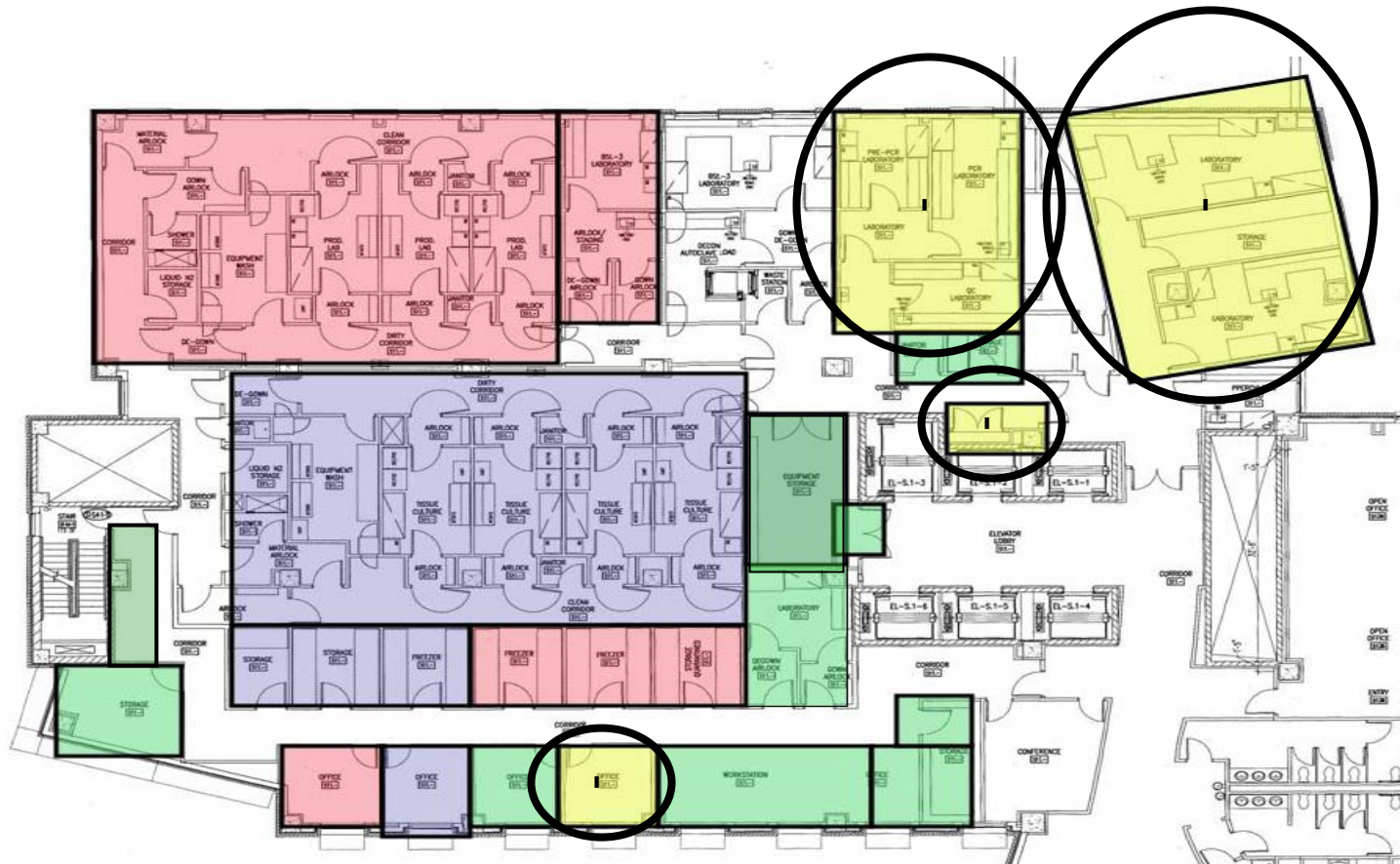

CCHMC Translational Core Facility (Winter 2008)

QA, Administration and Support: Material Repackaging Suite, dedicated administrative and Quality Assurance offices and archive areas.

