

Assisted Saliva Collection Kit Instructions for Home Use

Contents:

- CCHMC Specimen Transport Bag
- Cell Collection Kit Instructions
- Collection Kit
- Label

Contact us with questions or to request supplies:

513-636-4474

LabGeneticCounselors@cchmc.org

cincinnatichildrens.org/molecular-genetics

GENETICS AND GENOMICS DIAGNOSTIC LABORATORY

Cincinnati Children's Hospital Medical Center

3333 Burnet Avenue NRB 1042

Cincinnati, OH 45229-3039

513-636-4474

LabGeneticCounselors@cchmc.org

cincinnatichildrens.org/molecular-genetics

Please follow instructions below:

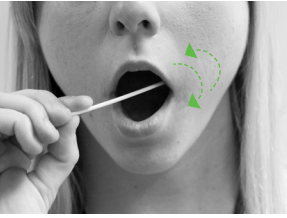

1. Do NOT eat or drink for 30 minutes before collection. Verify that the name and birthdate of the person providing the saliva sample is on the labeled tube. Remove a sponge from the packaging. Swab along the gums and inner cheek using the motion indicated in the image to the left, 15–20 times. Soak up as much saliva as possible on each pass.



2. Insert saturated sponge into the V-notch of funnel and wring saliva out of the sponge using a twisting and pushing motion. Using the same sponge, repeat step one on the opposite cheek and wring saliva into the funnel until the fluid (not bubbles) reaches the indicated fill line. (The second sponge can be used if the first sponge is damaged.)



3. When saliva fluid reaches the fill line, close the funnel lid tightly by folding the lid over the funnel and pushing down hard until you hear a loud click. The liquid in the funnel lid will be released into the tube when the lid is completely closed. The volume of fluid in the tube should be above the fill line at this point.

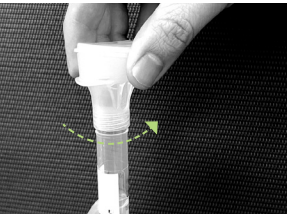

4. Unscrew the closed funnel top from the tube. Be careful not to spill fluid.

The funnel top and sponges can be discarded.



5. Place a NEW lid on the tube using the small round cap (with a **blue** sticker on top) that is included in the kit. Tightly screw on cap to seal the tube for transport. Shake the capped tube for 5 seconds.



6. Place tube inside specimen transport bag and seal. Place sealed bag and any paperwork that is included into the FedEx Clinical PAK and ship to CCHMC by dropping the PAK at a FedEx location.



Video instructions available at
www.youtube.com/watch?v=ql2dc39nZ94
or by scanning this QR code.